

Combination: Old vice base + new clamping jaws

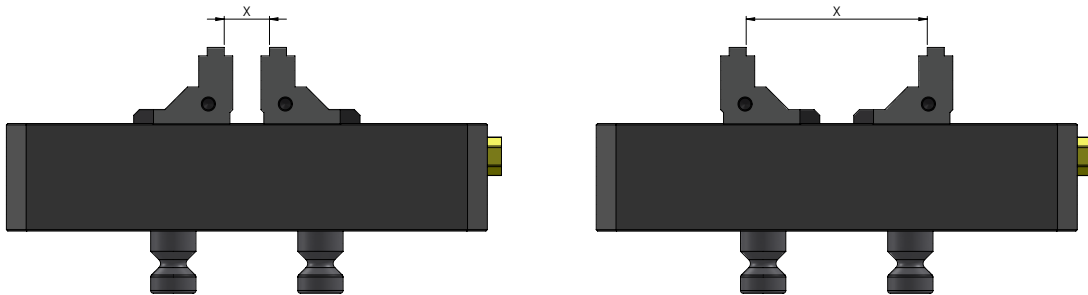

Makro-Grip® 5-Axis Vice

Compatibility: possible with limitations

Old vice version	New clamping jaws	Distance X when clamping with serrated jaws	
		Inside (left picture)	Outside (right picture)
47065 / 47105 / 47145	+ 48077-4620	Not compatible	
47085	+ 48085-7720	16 mm	57 mm
47120 / 47160 / 47200	+ 48077-7720	16 mm	64 mm
47155 / 47205 / 47255 / 47305 / 47355	+ 48125-2520	20 mm	88 mm

Clamping jaws cannot be moved together completely. There is no compatibility with jaw width 46 mm.

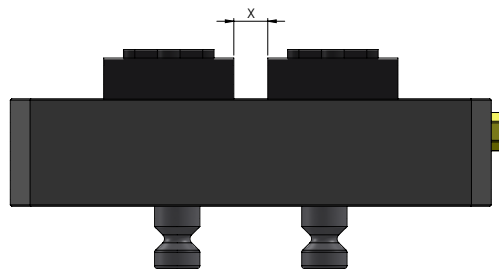

Profilo Profile Clamping Vice

Compatibility: possible with limitations

Old vice version	New base jaws	Distance X between the inner surfaces of the base jaws
49010	+ 49077	11 mm
49040 / 49080 / 49120	+ 49077	11 mm
49050 / 49100 / 49150 / 49200 / 49250	+ 49125	14 mm

Base jaws cannot be moved together completely.

Combination: **Old vice base + new clamping jaws**

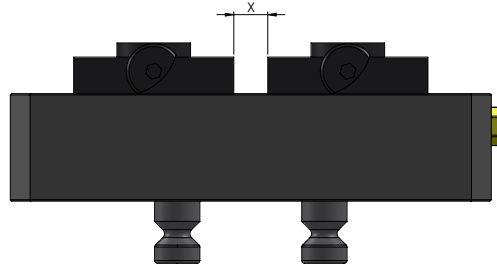

Avanti Profile Clamping Vice

Compatibility: possible with limitations

Old vice version	New base jaws	Distance X between the inner surfaces of the base jaws
44065 / 44105	+ 44771-46	Not compatible
44120 / 44160 / 44200	+ 44771-77	11 mm
44205 / 44255 / 44305 / 44355	+ 44251-125	15 mm

Base jaws cannot be moved together completely.

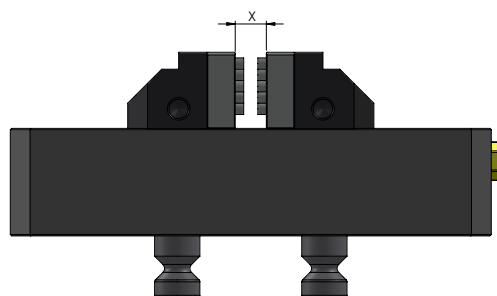

Vario-Tec Centring Vice

Compatibility: possible with limitations

Old vice version	New clamping jaws	Distance X between the inner surfaces of the clamping jaws
42057 / 42097 / 42137	+ 42018-77	11 mm
42102 / 42152 / 42202 / 42252	+ 42018-125	15 mm

Clamping jaws cannot be moved together completely.

Combination: New vice base + old clamping jaws

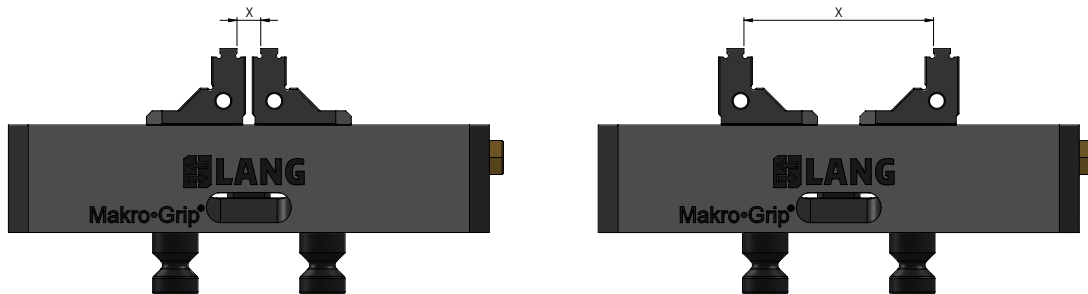

Makro-Grip® 5-Axis Vice

Compatibility: possible with limitations

New vice version	Old clamping jaws	Distance X when clamping with serrated jaws	
		Inside (left picture)	Outside (right picture)
48085-46 / 48120-46	+ 47046-20	Not compatible	
48085-77	+ 47085-20	8,4 mm	55 mm
48120-77 / 48160-77 / 48200-77	+ 47077-20	8,4 mm	67 mm
48155-125 / 48205-125 / 48255-125 / 48305-125 / 48355-125	+ 47125-20	6 mm	88 mm

Clamping jaws cannot be moved together completely, except for the internal clamping on Makro-Grip® 125 (green figure). There is no compatibility with jaw width 46 mm.



Profilo Profile Clamping Vice

Compatibility: possible without restrictions

New vice version	Old base jaws	Distance between the inner surfaces of the base jaws
49010-77	+ 49771	0 mm
49040-77 / 49080-77 / 49120-77	+ 49771	0 mm
49050-125 / 49100-125 / 49150-125 / 49200-125 / 49250-125	+ 49251	0 mm

Base jaws can be moved together completely.

Combination: **New vice base + old clamping jaws**



Avanti Profile Clamping Vice

Compatibility: possible with limitations

New vice version	Old base jaws	Distance between the inner surfaces of the base jaws
44085-46 / 44120-46	+ 44461	Not compatible
44120-77 / 44160-77 / 44200-77	+ 44771	0 mm
44205-125 / 44255-125 / 44305-125 / 44355-125	+ 44251	0 mm

Base jaws can be moved together completely (green figures). There is no compatibility with jaw width 46 mm.



Vario-Tec Centring Vice

Compatibility: possible without restrictions

New vice version	Old clamping jaws	Distance between the inner surfaces of the clamping jaws
42057-77 / 42097-77 / 42137-77	+ 42077	0 mm
42102-125 / 42152-125 / 42202-125 / 42252-125	+ 42125	0 mm

Clamping jaws can be moved together completely.

Combination: **Old vice base with old centre jaw + new clamping jaws**

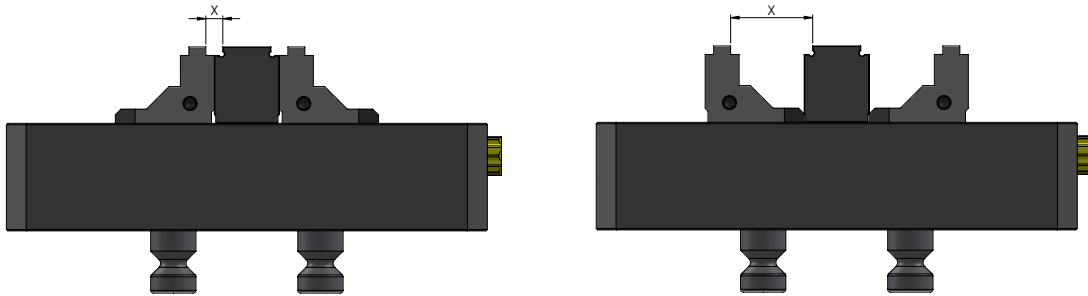

Makro-Grip® 5-Axis Vice

Compatibility: possible with limitations

Old vice version	New clamping jaws	Distance X when using a centre jaw	
		Inside (left picture)	Outside (right picture)
47065 / 47105 / 47145 with respective centre jaw	+ 48077-4620	Not compatible	
47085 with centre jaw	+ 48085-7720	6 mm	26 mm
47120 / 47160 / 47200 with respective centre jaw	+ 48077-7720	6 mm	29 mm
47155 / 47205 / 47255 / 47305 / 47355 with respective centre jaw	+ 48125-2520	6 mm	38 mm

Clamping jaws can be moved together completely (green figures). There is no compatibility with jaw width 46 mm.

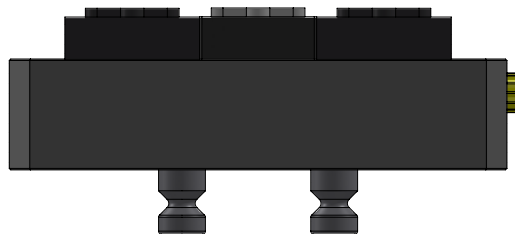

Profilo Profile Clamping Vice

Compatibility: possible without restrictions

Old vice version	New base jaws	Distance between the inner surfaces of the clamping jaws
49080 / 49120 with respective centre base jaw	+ 49077	0 mm
49100 / 49150 / 49200 / 49250 with respective centre base jaw	+ 49125	0 mm

Base jaws can be moved together completely.

Combination: New vice base with new centre jaw + old clamping jaws

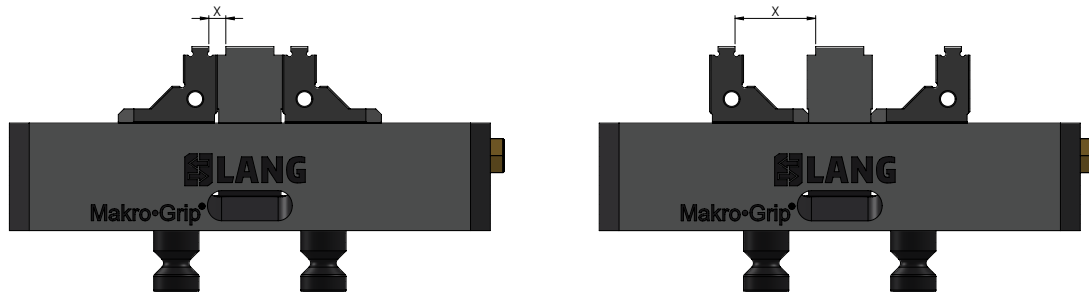

Makro-Grip® 5-Axis Vice

Compatibility: possible without restrictions

New vice version	Old clamping jaws	Distance X when using a centre jaw TGXX17		Distance X when using a centre jaw TGXX27	
		Inside (left)	Outside (right)	Inside (left)	Outside (right)
48085-77 with centre jaw	+ 47077-20	6 mm	29 mm	6 mm	29 mm
48120-77 / 48160-77 / 48200-77 with respective centre jaw	+ 47077-20	6 mm	29 mm	6 mm	29 mm
48155-125 / 48205-125 / 48255-125 / 48305-125 / 48355-125 with respective centre jaw	+ 47125-20	Not applicable		6 mm	38 mm

Centre jaws and clamping jaws can be moved together completely (green figures).
Makro-Grip® 125 centre jaws with 17 mm thickness are not available.



Profilo Profile Clamping Vice

Compatibility: possible without restrictions

New vice version	Old base jaws	Distance between the inner surfaces of the base jaws
49080-77 / 49120-77 with respective centre base jaw	+ 49771	0 mm
49100-125 / 49150-125 / 49200-125 / 49250-125 with respective centre base jaw	+ 49251	0 mm

Centre base jaw and base jaws can be moved together completely.

Combination: **New vice base with new centre jaw + old clamping jaws**

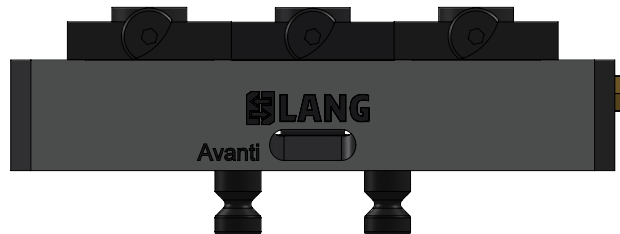

Avanti Profile Clamping Vice

Compatibility: possible without restrictions

New vice version	Old base jaws	Distance between the inner surfaces of the base jaws
44120-46 with centre base jaw	+ 44461	Not compatible
44200-77 with centre base jaw	+ 44771	0 mm
44255-125 / 44305-125 / 44355-125 with respective centre base jaw	+ 44251	0 mm

Centre base jaw and base jaws can be moved together completely (green figures). There is no compatibility with jaw width 46 mm.